

**SIGSAUER®**

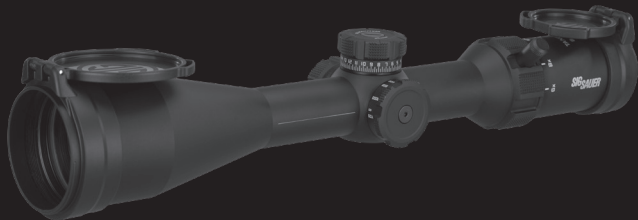

**TANGO®**

TANGO-SPR™ RIFLESCOPES

OPERATOR'S MANUAL

## TABLE OF CONTENTS

Introduction . . . . .	3
Features . . . . .	3
Contents . . . . .	4
Product Identification . . . . .	4
Mounting the Sight . . . . .	6
Operation . . . . .	10
Sight Adjustments . . . . .	12
Maintenance . . . . .	18
Troubleshooting . . . . .	18
SIG SAUER® Infinite Guarantee™ . . . . .	20

Please visit [sigsauer.com](http://sigsauer.com) for Owners Manual downloads.

## INTRODUCTION

SIG SAUER demands the most of their products. The TANGO-SPR® series riflescope is no exception. Offering maximum light transmission and optical clarity, the TANGO-SPR riflescope is built to withstand the rigors that modern shooters and hunters require.

## FEATURES

- SIG SAUER® Infinite Guarantee™
- IPX7 Waterproof rating
- European style eyepiece for smooth, fast, and precise reticle adjustment
- LD Low Dispersion Glass
- BDC Reticles
- HELLFIRE® Illuminated Reticles (Model Dependent)

**CONTENTS:**

- Riflescope
- Flipback Lens Covers
- Manual
- CR2032 battery (Model Dependent)
- 30mm Scope Mount (not shown)

**PRODUCT IDENTIFICATION**

- A** Elevation Dial
- B** Windage Dial: Under Cap
- C** Removable Throw Lever
- D** Objective Lens
- E** 30mm Main Tube
- F** Side Focus (Model Dependent)
- G** Power Selector Ring
- H** Diopter Adjustment Ring
- I** Ocular Lens

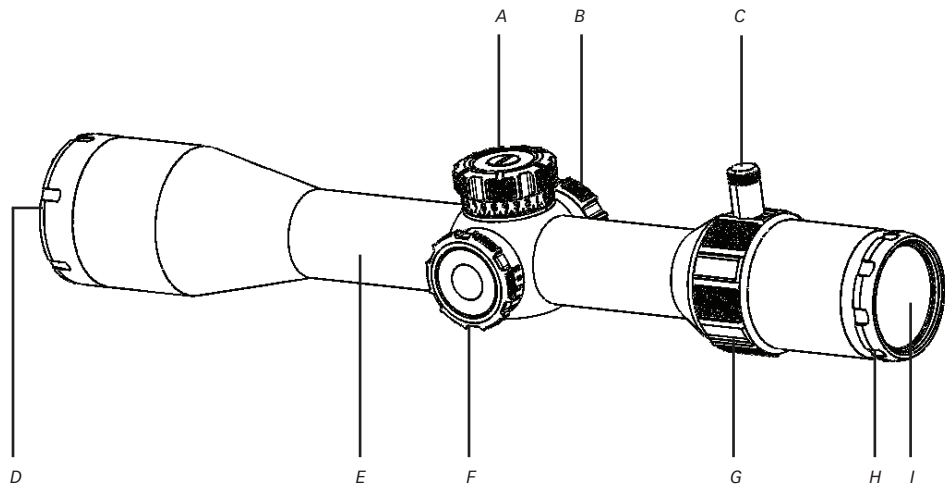



## **WARNING**

Before working on your TANGO-SPR® riflescope always ensure that the firearm is unloaded with the safety on.

---

### **Mounting the riflescope**

Choose rings and bases that correspond to your firearms action and the diameter of your riflescope's maintube. In order to maintain a comfortable cheek weld always mount your riflescope with the lowest possible ring height. Make sure that there is no interference with any of the moving parts of your firearm.

## Set proper eye relief

Slightly loosen the riflescope rings and position the riflescope as far forward as it will mount. For adjustable power riflescopes select the highest possible power. Mount the rifle in a comfortable and repeatable, natural position. Adjust the position of the riflescope backwards until you have maximum field of view in your riflescope.

Ensure that the vertical crosshair of the riflescope matches the vertical centerline of your rifle and tighten the rings and bases to the correct torque

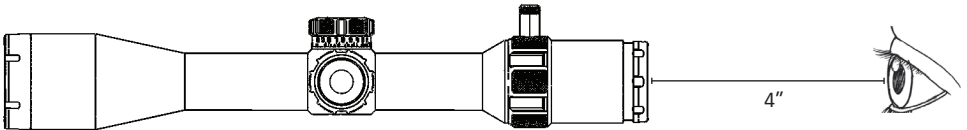

**! WARNING**

- **INGESTION HAZARD:** This product contains a button cell or coin battery.
- **DEATH** or serious injury can occur if ingested.
- A swallowed button cell or coin battery can cause **Internal Chemical Burns** in as little as **2 hours**.
- **KEEP** new and used batteries **OUT OF REACH of CHILDREN**.
- **Seek immediate medical attention** if a battery is suspected to be swallowed or inserted inside any part of the body.



- Keep in original package until ready to use.
- Remove and immediately recycle or dispose of used batteries according to local regulations and keep away from children. Do NOT dispose of batteries in household trash or incinerate.
- For treatment information call, The National Battery Ingestion Hotline (NBH) 1-(800) 498-8666.



## **WARNING**

- Even used batteries may cause severe injury or death.
- Call a local poison control center for treatment information.
- Compatible battery: CR2032    Nominal voltage: 3V
- Do not mix old and new batteries, different brands or types of batteries, such as alkaline, carbon-zinc, or rechargeable batteries.
- Ensure the batteries are installed correctly according to polarity (+ and -).
- Remove and immediately recycle or dispose of batteries from equipment not used for an extended period of time according to local regulations.
- Non-rechargeable batteries are not to be recharged.
- Do not force discharge, recharge, disassemble, heat above 212°F (100°C) or incinerate. Doing so may result in injury due to venting, leakage or explosion, resulting in chemical burns.
- Always completely secure the battery compartment. If the battery compartment does not close securely, stop using the product, remove the batteries, and keep them away from children.

 **WARNING:** CANCER AND REPRODUCTIVE HARM – [www.P65Warnings.ca.gov](http://www.P65Warnings.ca.gov)

**NOTICE:** Export restrictions may apply – this product may be controlled either by the ITAR or EAR.



## OPERATION

### INSTALLING THE BATTERY

Some TANGO-SPR™ riflescopes are equipped with illuminated reticles and require a CR2032 Battery. To install the battery:

1. Use a cartridge case or coin to turn the battery port cover counterclockwise and remove it from the battery port.
2. Place the CR2032 battery into the battery port with the plus side (+) facing outward.
3. Reinstall the battery port cover by rotating the cap in the clockwise (CW) direction to 10 in-lbs.

Note – failure to properly torque the battery cap clockwise (CW) direction to 10 in-lbs could lead to ingestion hazard of coin battery, intermittent LED illumination or allow moisture into the battery compartment.

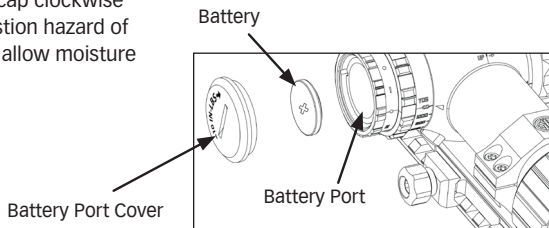

## ILLUMINATION BRIGHTNESS LEVEL

- Rotate illumination power selector ring to select the illumination brightness level that best suits your conditions.
- Brightness level settings alternate between on and off locations.
- Numerical values indicate active illumination settings.
- Higher values indicate brighter illumination.

Illumination Power Selector Ring

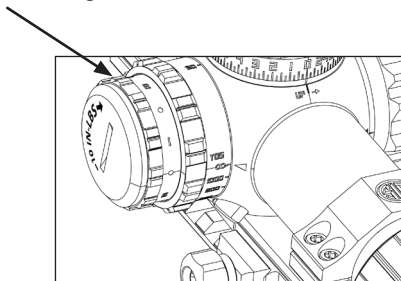

## SIGHT ADJUSTMENTS

The riflescope will come optically centered. This should get you close to your rifles zero out of the box.

### Focusing the reticle with the diopter

Aim the riflescope at a light object to maximize the contrast of the reticle.

Turn the diopter until the reticle comes into focus.

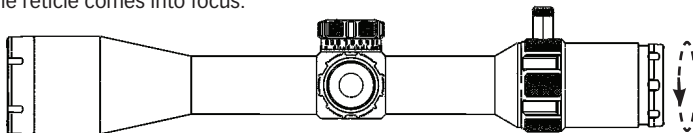

### Adjusting Power

TANGO-SPR® riflescopes are variable power. In order to increase the power setting rotate the power selector ring clockwise. Turn the power selector ring until the image is magnified to the desired range.

### Bore sighting

If you are installing the riflescope from other than its factory settings it is best to bore site your riflescope. This will give you a coarse zero and will require further adjustments.

With the rifle in a firm rest, remove the bolt from your rifles action (with AR style rifles remove the rifles upper from its lower assembly and remove the bolt carrier). Look through the rifles barrel from the rear of the rifle and aim it so that your target is centered. Without moving the position of the barrel, use the elevation and windage adjustments of your riflescopes reticle so that it is also in the center of the target.

## **Point of Impact (POI) corrections**

POI corrections should be done using the center of a three shot group. If you are not able to get a consistent three shot group then you will need to trouble shoot your rifle further.

If your POI is located to the left of your point of aim (POA) then you need to adjust the windage to the right. The value of each click is marked on your riflescope. To move your POI to the right you will need to turn the windage turret counter-clockwise. To move your POI left turn the windage turret clockwise.

If your POI is located below your POA then you need to adjust your elevation up. The value of each click is marked on your riflescope. To move your POI up you will need to turn the elevation turret counter-clockwise. To move your POI down turn the elevation turret clockwise.

The goal of these adjustments is for your point of impact to match up with your point of aim. You will need to make windage or elevation adjustments in order to accomplish this.

## **Re-setting your zero - TANGO-SPR™**

To reset the zero on your TANGO-SPR rifle scope, loosen the 2.5mm hex screw on the adjustment dial and rotate the dial to zero. Once you are back to zero, tighten the 2.5mm hex screw. Replace the dial cap.

## RESETTING THE ELEVATION DIAL

Before resetting the zero of the elevation dial, see section 7.5.3 and adjust the POI elevation so that it is located where you want it in relation to your POA.

To reset the zero:

1. Use a cartridge case or a coin to unscrew elevation dial screw counterclockwise and remove it.
2. Lift elevation dial off the hub.

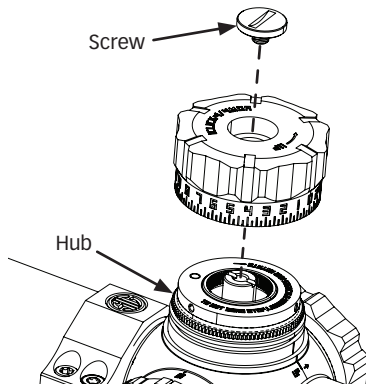

3. Use 0.05 in. hex wrench to turn three zero stop dial set screws (1) counterclockwise until loose.
4. Turn zero stop dial clockwise until it stops.
5. Use 0.05 in. hex wrench to turn three zero stop dial set screws clockwise until finger tight.
6. Align the **0** on elevation dial with zero indicator line on the elevation turret.
7. Use a cartridge case or a coin to turn elevation dial screw clockwise into turret until finger tight.
8. Once your POI elevation is located where you want it in relation to your POA, push elevation dial down to lock.

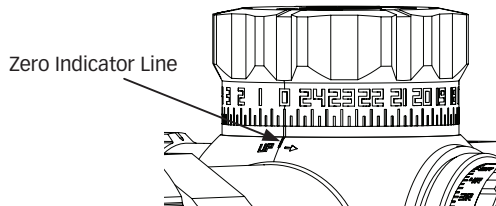
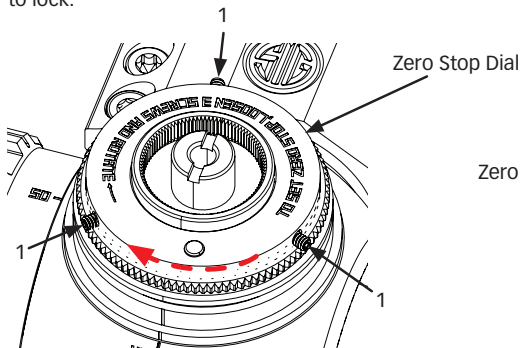

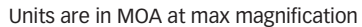



## SFP FL-4 RETICLE SUBTENSIONS

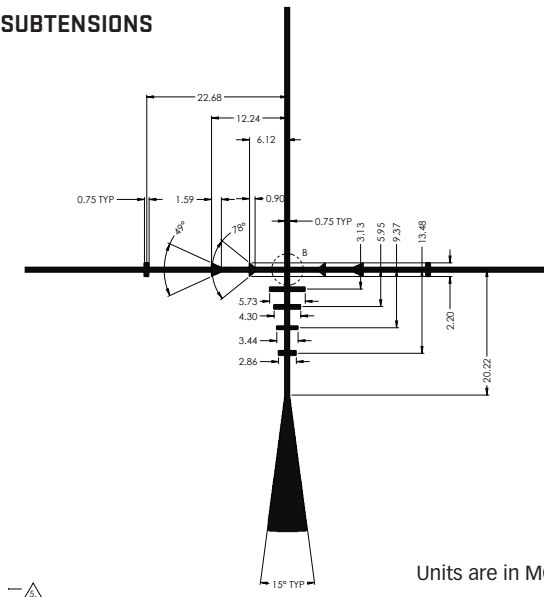

Units are in MOA at max magnification



## **MAINTENANCE**

Your SIG SAUER riflescope requires very low maintenance.

- If your riflescope came with turret caps make sure that they are installed when you are not making windage or elevation adjustments.
- Keep your lenses clear by using a soft cloth or lens pen. The best way to maintain image quality is by keeping your lenses clear of dirt and dust that cause scratches.

## **TROUBLESHOOTING**

### **POI changes between groups**

- Check that all of your mounts are tightened to the correct torque spec
- Check/Clean your rifle
- Check for variations in ammunition

This page intentionally left blank.



## **SIG SAUER® Infinite Guarantee™**

SIG SAUER® has a history of quality and reliability that dates back more than 250 years. We understand the importance of true dependability whether it be in the line of duty, at the shooting range or on your next hunt and we continually strive to deliver products that meet and exceed the expectations of even the most demanding customers. That's why SIG SAUER is proud to offer our INFINITE GUARANTEE\* on all our firearms, optics, and suppressors.

Our promise: We warrant that your new SIG SAUER firearm, optic, or suppressor was originally manufactured free of defects in material, workmanship, electrical, optical, and mechanical function. We will repair your SIG SAUER product in the event it becomes damaged or is defective in any way, at no charge to you. If we cannot repair your product, we will replace it or, if we cannot replace it, we will provide you with a replacement of equal value. All with no questions asked, forever.

### *SIG SAUER® INFINITE GUARANTEE*

- Fully Transferable
- No Warranty Card Required
- No Receipt Required
- No Time Limit Applies
- No Charge

Please note that our Infinite Guarantee excludes coverage for intentional damage, misuse, cosmetic damage that does not affect the performance of the optic, loss, theft, or unauthorized repair or modification. Excludes Tritium components.

Customers seeking warranty coverage must first obtain a Return Merchandise Authorization (RMA) by contacting SIG SAUER Customer Service and return the product unloaded and freight prepaid.

ANY WARRANTIES IMPLIED BY LAW, INCLUDING ANY IMPLIED WARRANTIES OF MERCHANTABILITY OR FITNESS FOR A PARTICULAR PURPOSE, ARE EXPRESSLY LIMITED IN DURATION TO THE DURATION OF THIS WRITTEN WARRANTY PERIOD. REPAIR, ALTERATION, OR REPLACEMENT AS PROVIDED HEREIN IS YOUR EXCLUSIVE REMEDY FOR ANY DEFECTIVE PRODUCT. IN NO EVENT SHALL SIG SAUER OR ANY COMPANY AFFILIATED WITH SIG SAUER BE LIABLE FOR ANY SPECIAL, INCIDENTAL, OR CONSEQUENTIAL DAMAGES OF ANY KIND ARISING OUT OF THE PURCHASE OR USE OF THIS PRODUCT, WHETHER BASED UPON CONTRACT, TORT, STATUTE, OR OTHERWISE. Some states do not allow the limitation of implied warranties, or the exclusion or limitation of incidental or consequential damages, so some or all of the above limitations or exclusions may not apply to you. This warranty gives you specific legal rights, and you may also have other rights which vary from State to State.

This warranty applies to commercial customers only and does not apply to government, non-commercial, or non-US customers. Non-US COMMERCIAL CUSTOMERS MUST PURCHASE PRODUCT THROUGH AN AUTHORIZED SIG SAUER DEALER WITHIN THEIR COUNTRY OF RESIDENCE FOR THIS WARRANTY TO APPLY.

**NOTES:**

**NOTES:**



**FOR PRODUCT SERVICE ON THIS MODEL, PLEASE CALL 603-610-3000**

**12100 SW Tualatin Road, Tualatin, OR 97062 USA**